

Painting Projects for Fayette County Public Schools (RFP 24-037-075)
Addendum 1

1. Site maps for locations with pending projects.
 - a. See attached site maps with project areas highlighted.

* Paint Hallways, Bathrooms, Interior and Exterior Door Frames

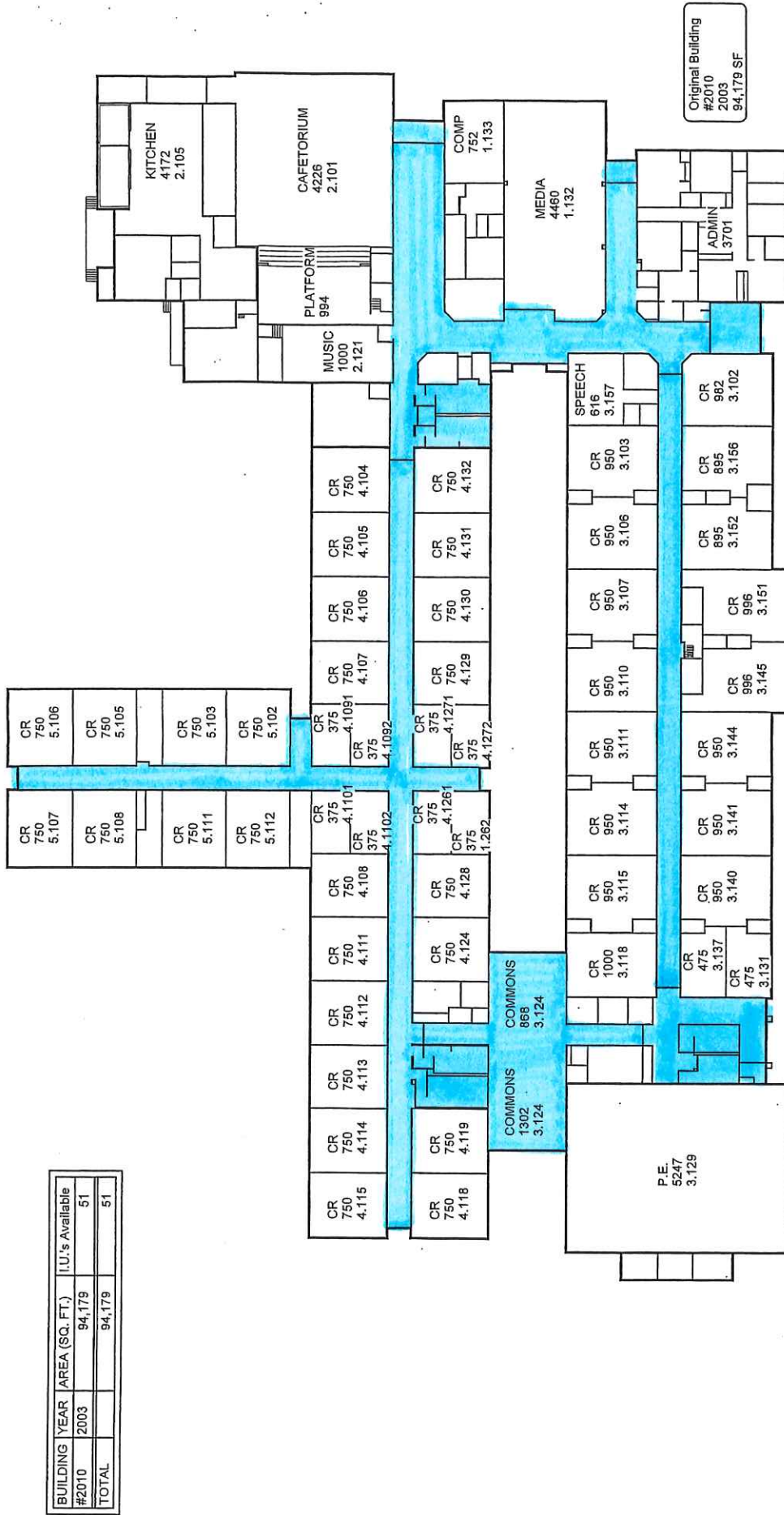

BUILDING YEAR	AREA (SQ. FT.)	I.U.'s Available
#2010	94,179	51
TOTAL	94,179	51

CRABAPPLE ELEMENTARY SCHOOL

FACILITY NO.: 0104

ACREAGE: 20 ACRES +/-

Fayette County Board of Education

* Paint Hallways and Bathrooms

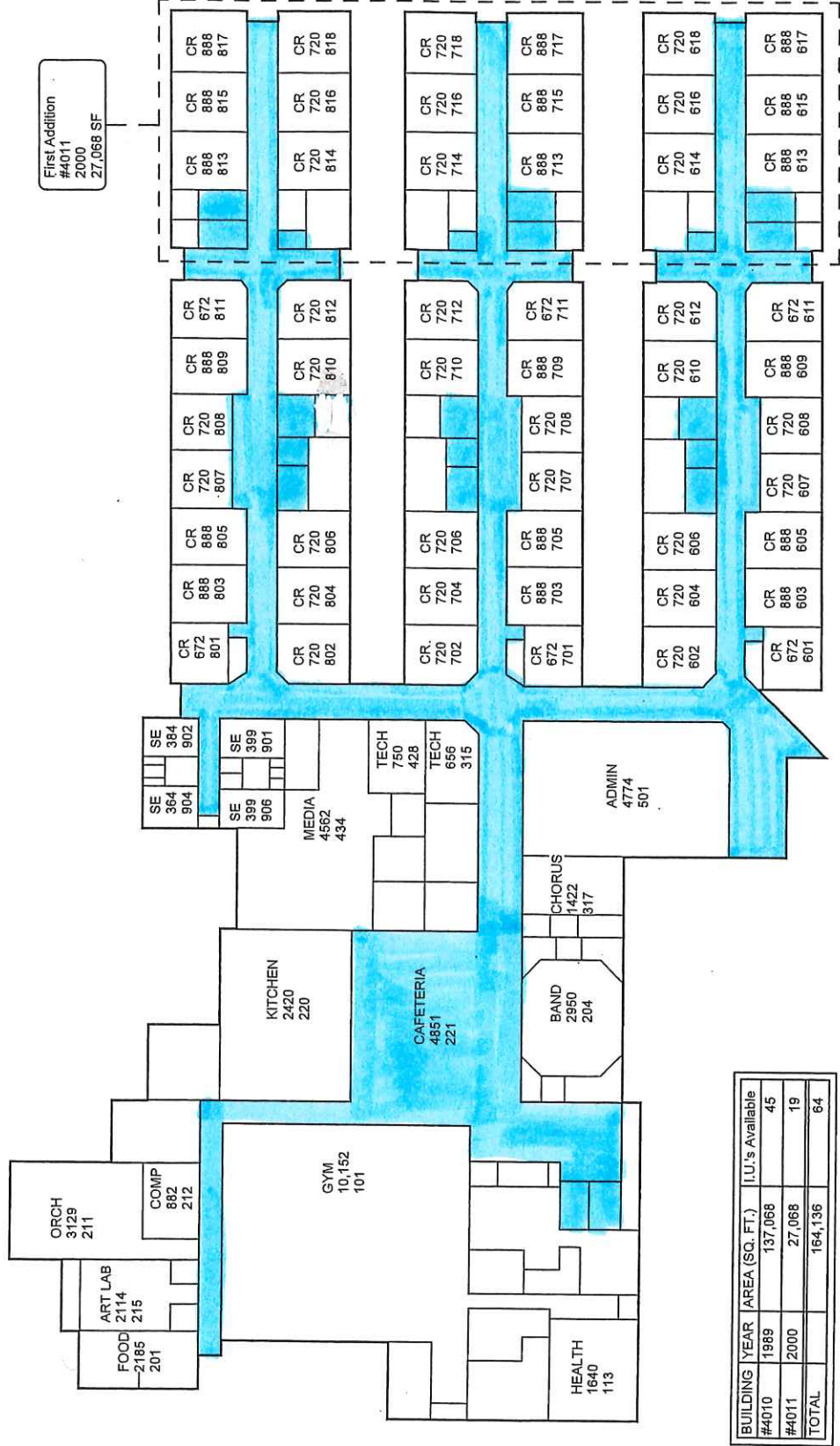

Original Building
#4010
1989
137,068 SF

BUILDING YEAR	AREA (SQ. FT.)	I.U.'s Available
#4010	137,068	45
#4011	27,068	19
TOTAL	164,136	64

FLAT ROCK MIDDLE SCHOOL

ACREAGE: 20 ACRES +/-

FACILITY NO.: 0491

Fayette County Board of Education

* Paint all admin offices gray

BUILDING	YEAR	AREA (SQ. FT.)	I.U.'s Available
#2010	2009	86,172	43
TOTAL		86,172	43

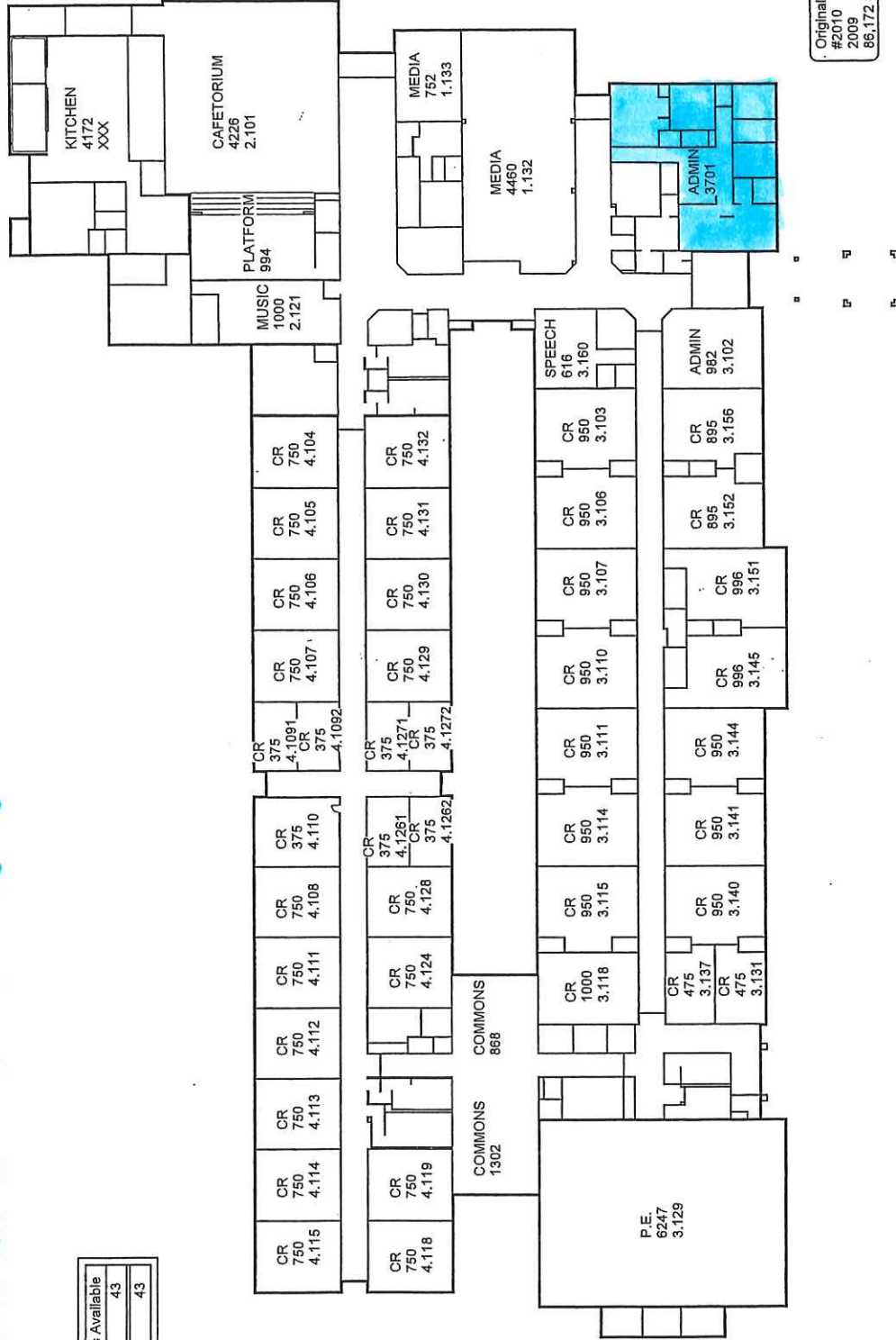

Original Building
#2010
2009
86,172 SF

INMAN ELEMENTARY SCHOOL

ACREAGE: 20 ACRES +/-

FACILITY NO.: 0109

Fayette County Board of Education

* Paint Music room

BUILDING YEAR	AREA (SQ. FT.)	I.U.'s Available
#2010	87,734	46
TOTAL	87,734	46

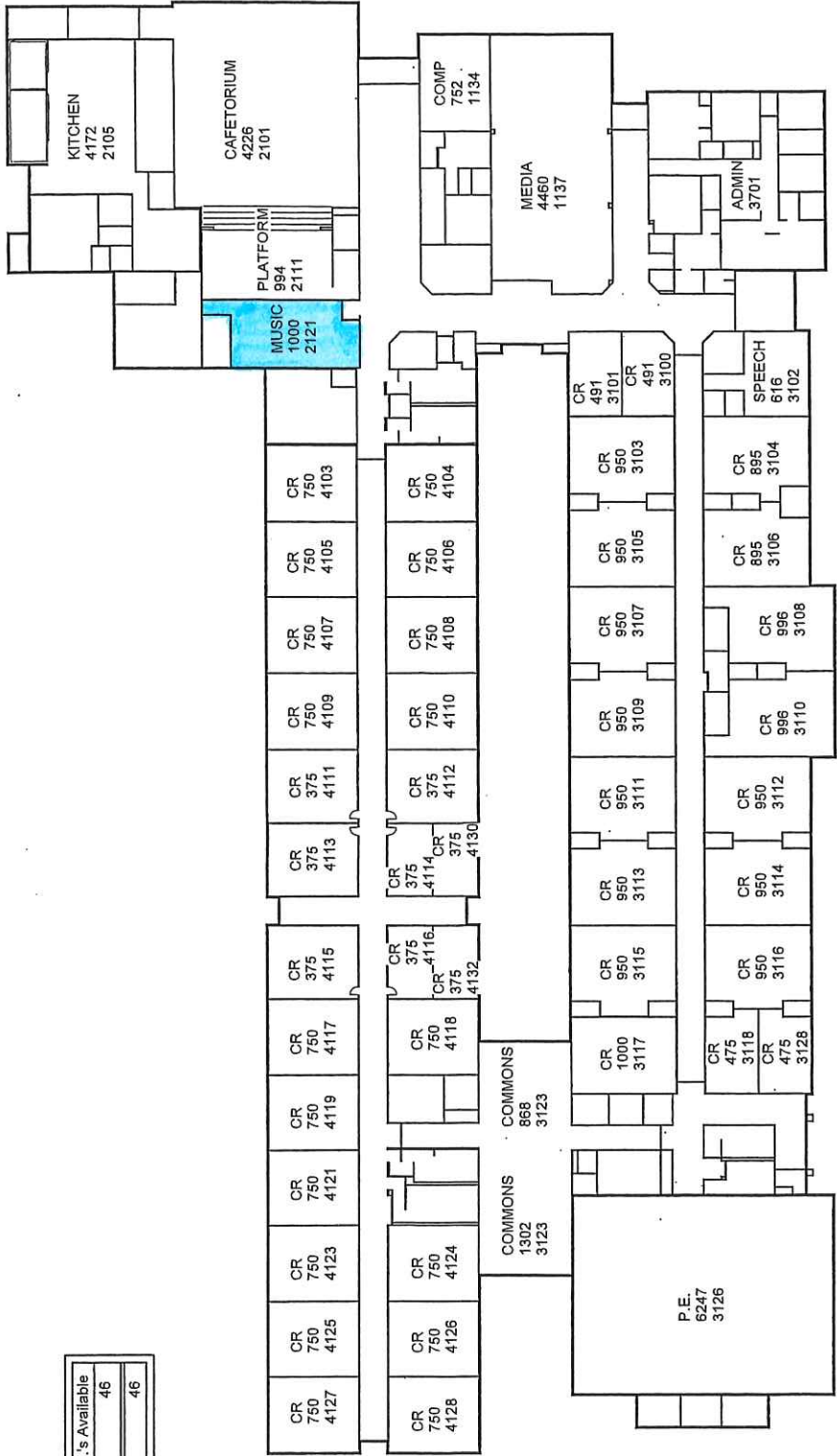

Original Building
#2010
1995
87,734 SF

KEDRON ELEMENTARY SCHOOL

ACREAGE: 19.49 ACRES

FACILITY NO.: 0196

Fayette County Board of Education

*Paint Cafeteria ceiling

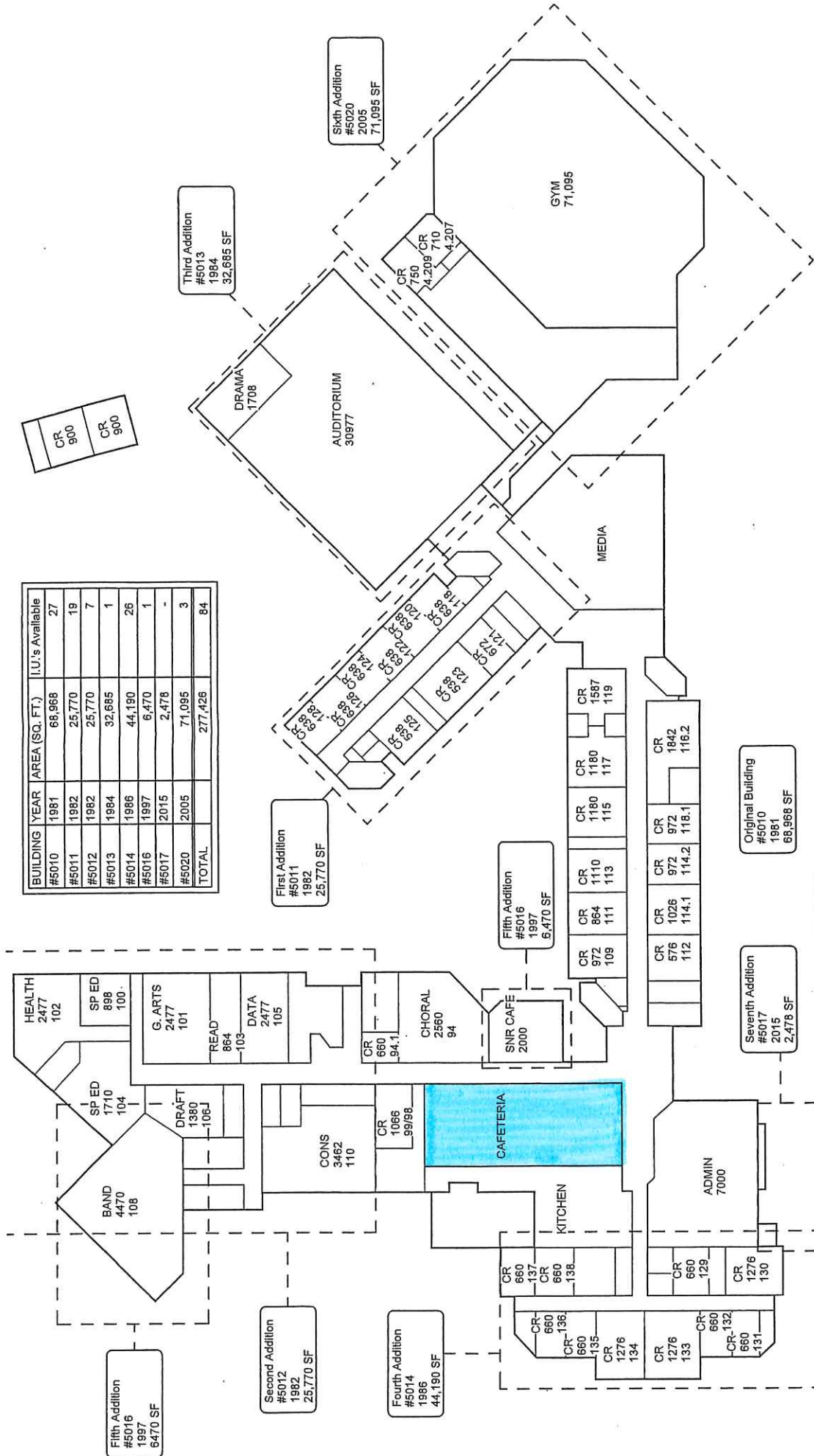

BUILDING	YEAR	AREA (SQ. FT.)	I.U.'s Available
#5010	1981	68,968	27
#5011	1982	25,770	19
#5012	1982	25,770	7
#5013	1984	32,685	1
#5014	1986	44,190	26
#5016	1997	6,470	1
#5017	2015	2,478	-
#5020	2005	71,095	3
TOTAL		277,426	84

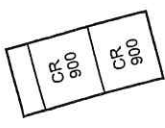

Third Addition
#5013
1984
32,685 SF

Sixth Addition
#5020
2005
71,095 SF

First Addition
#5011
1982
25,770 SF

Fifth Addition
#5016
1997
6,470 SF

Original Building
#5010
1981
68,968 SF

Seventh Addition
#5017
2015
2,478 SF

Fifth Addition
#5016
1997
6,470 SF

Second Addition
#5012
1982
25,770 SF

Fourth Addition
#5014
1986
44,190 SF

LOWER LEVEL

Fayette County Board of Education

MCINTOSH HIGH SCHOOL

ACREAGE: 35.4 ACRES

FACILITY NO.: 0182

*Paint Second Floor bridge

BUILDING YEAR	AREA (SQ. FT.)	I.U.'s Available
#5010	68,968	27
#5011	25,770	19
#5012	25,770	7
#5013	32,685	1
#5014	44,190	26
#5016	6,470	1
#5017	2,478	-
#5020	71,095	3
TOTAL	277,426	84

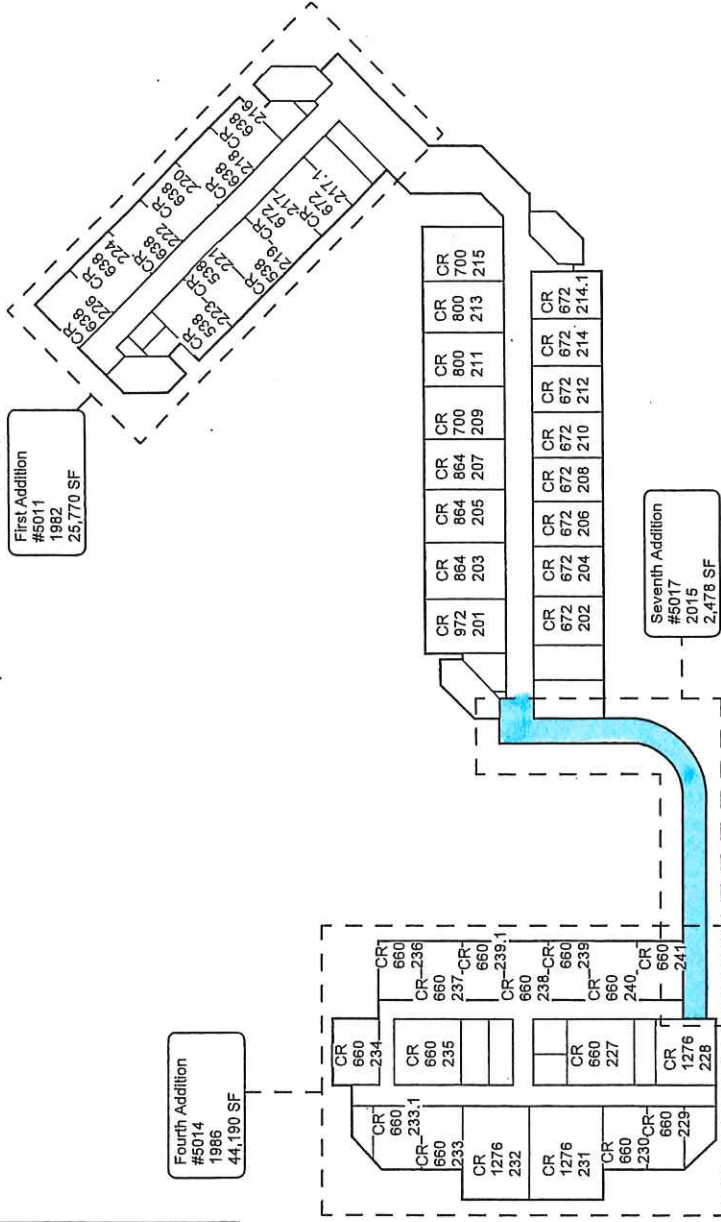

UPPER LEVEL

MCINTOSH HIGH SCHOOL

ACREAGE: 35.1 ACRES

FACILITY NO.: 0182

Fayette County Board of Education

*Paint Hallways and Bathrooms

BUILDING YEAR	AREA (SQ. FT.)	I.U.'s Available
#2010 1968	28,300	20
#2011 1974	22,032	13
#2012 1974	7,400	4
#2020 1984		ABANDONED
#2013 1995	2,133	-
#2014 2017	10,715	5
#2021 2017	7,342	1
TOTAL	77,922	43

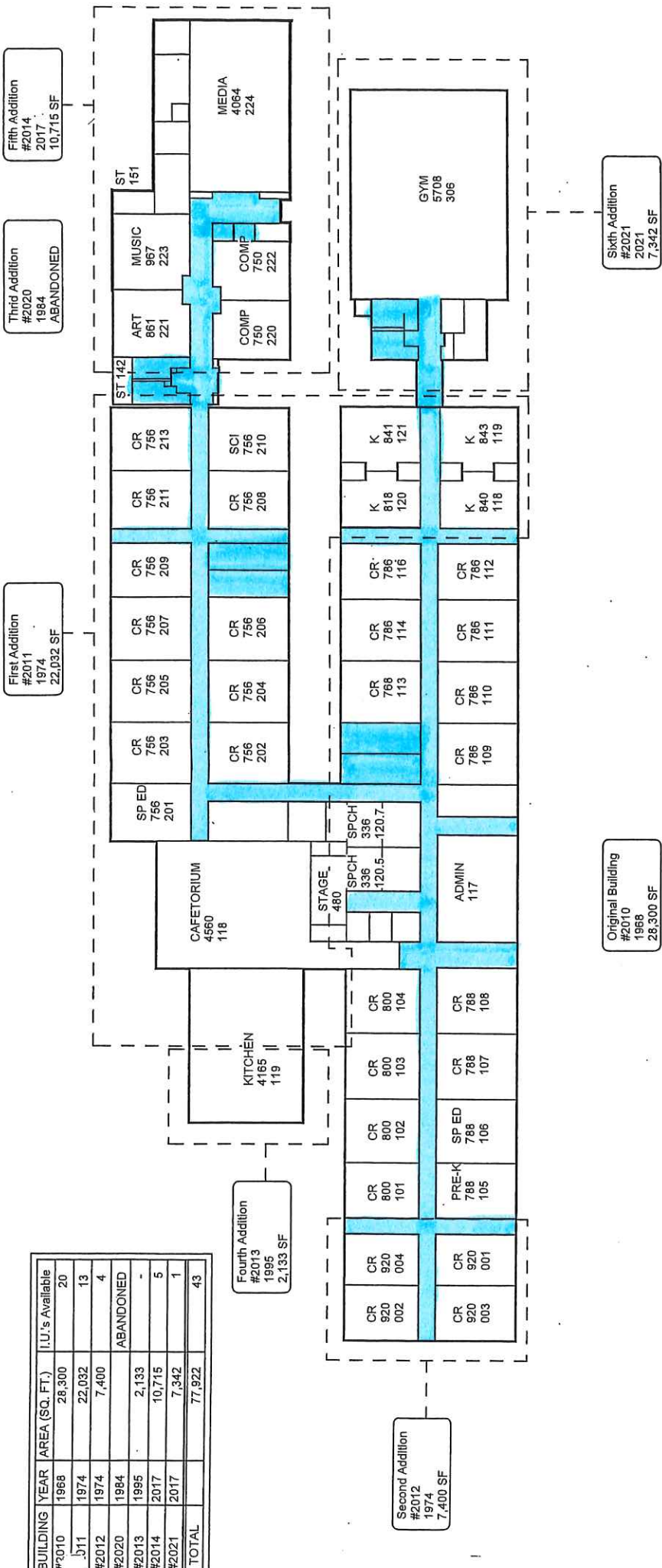

First Addition
#2011
1974
22,032 SF

Third Addition
#2020
1984
ABANDONED

Fifth Addition
#2014
2017
10,715 SF

Second Addition
#2012
1974
7,400 SF

Fourth Addition
#2013
1995
2,133 SF

Original Building
#2010
1968
28,300 SF

Sixth Addition
#2021
2021
7,342 SF

PEACHTREE CITY ELEMENTARY SCHOOL

ACREAGE: 15.1 ACRES +/-

FACILITY NO.: 1052

Fayette County Board of Education

* Paint Gym

BUILDING	YEAR	AREA (SQ. FT.)	I.U.'s Available
#2010	1996	87,734	46
#2011	2006	6,864	6
TOTAL		94,598	52

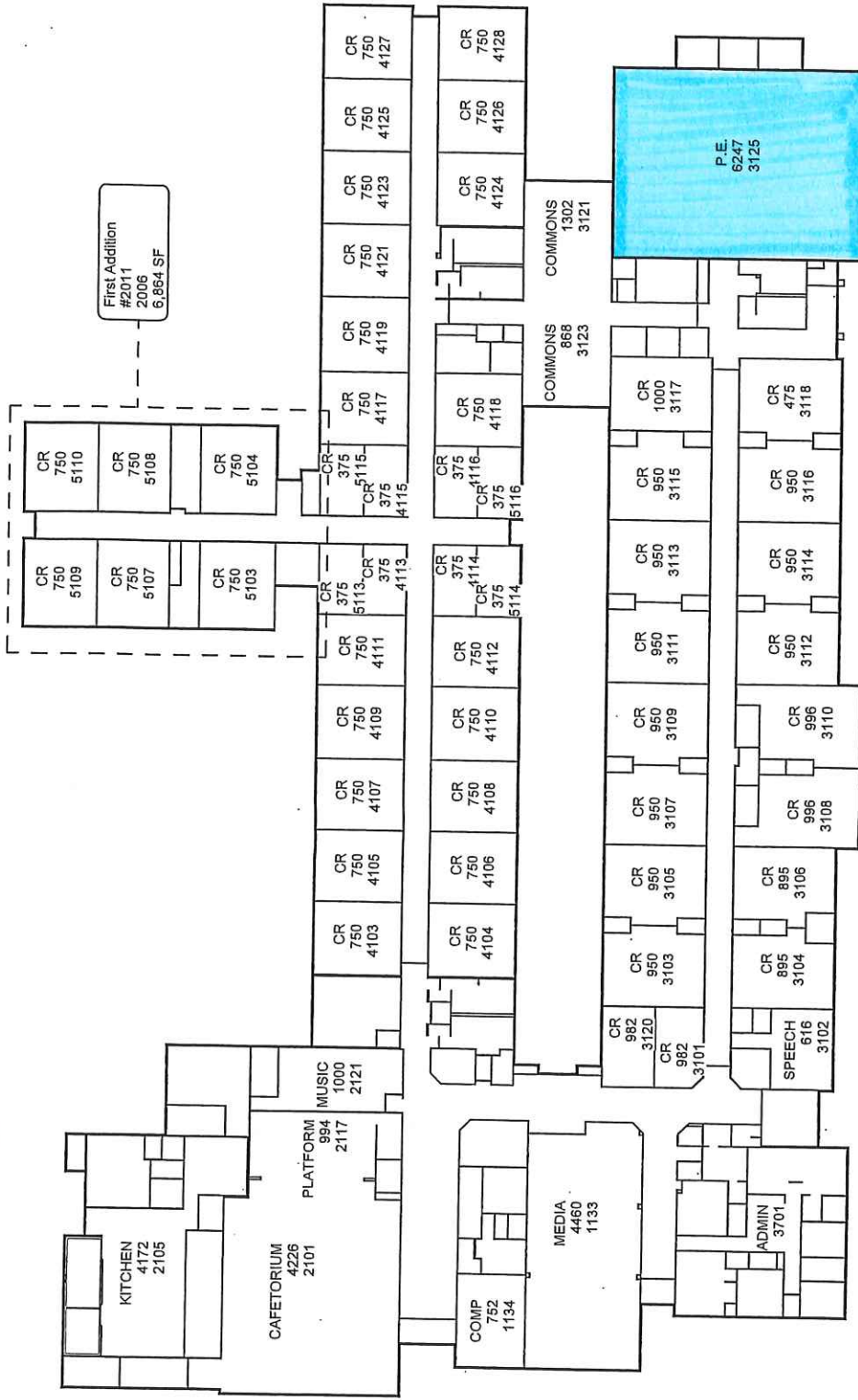

Original Building
#2010
1996
87,734 SF

SPRING HILL ELEMENTARY SCHOOL

ACREAGE: 12 ACRES

FACILITY NO.: 0296

Fayette County Board of Education

*Paint all student bathrooms

BUILDING	YEAR	AREA (SQ. FT.)	I.U.'s Available
#5010	2004	249,655	78
TOTAL		249,655	78

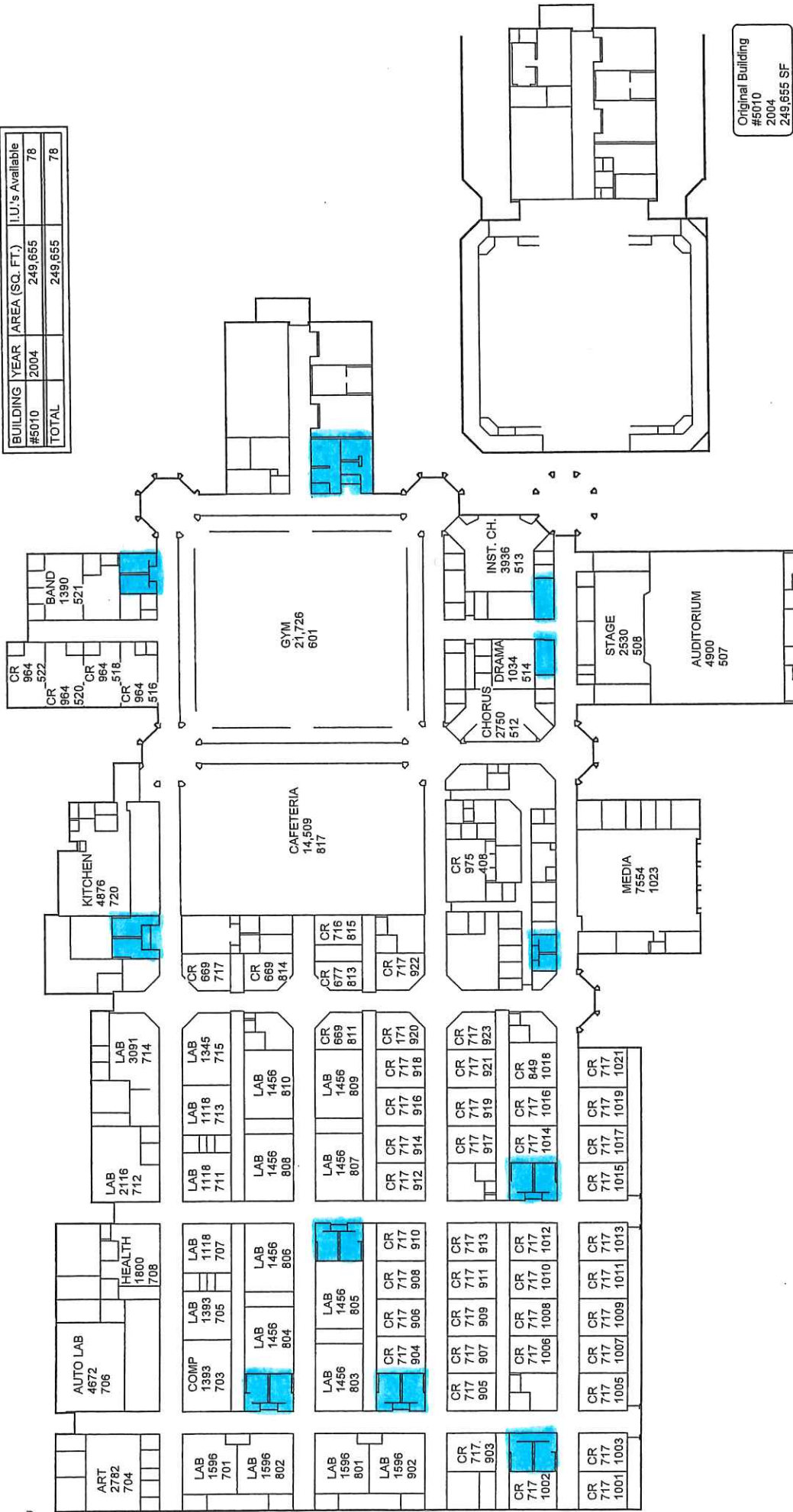

WHITEWATER HIGH SCHOOL

ACREAGE: 20 ACRES +/-

FACILITY NO.: 0109

Fayette County Board of Education